

SMILE

Food Machanic Service

2019



ยิ้มให้กับพวกเรา 😊



YOUR AUTOMATED FOOD
PROCESSING MACHINERY



COMPANY PROFILE



SMILE (2019) CO., LTD.

SMILE(2019) is a leader in the food processing machinery industry. Since 2014, we've been committed to the research and development of advanced machine food processing and building strong partnerships with our customer.

บริษัท สมายล์(2019) จำกัด ก่อตั้งเมื่อ วันที่ 25 กรกฎาคม 2557

Sausage Making Process

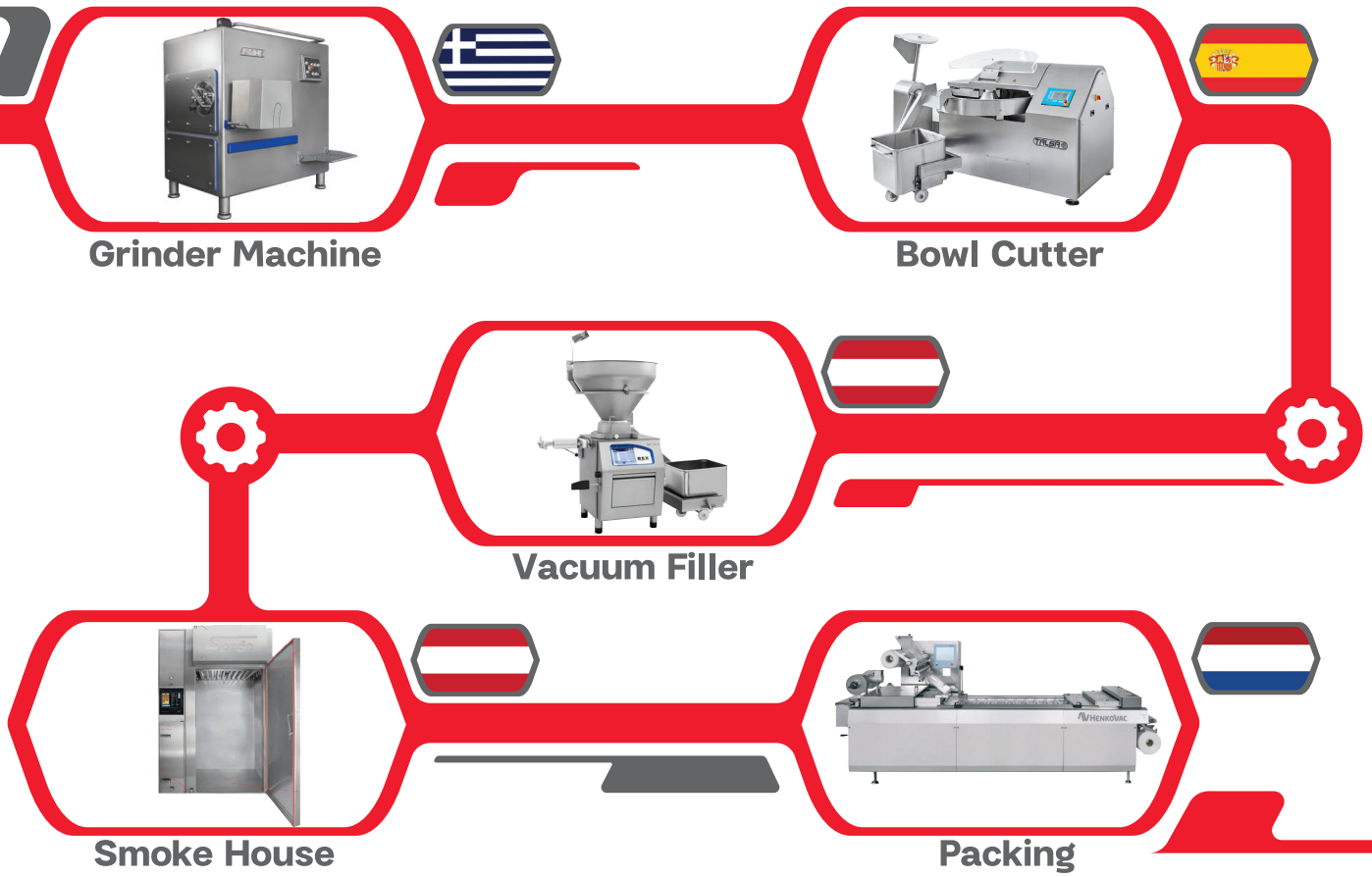

Knife Factory

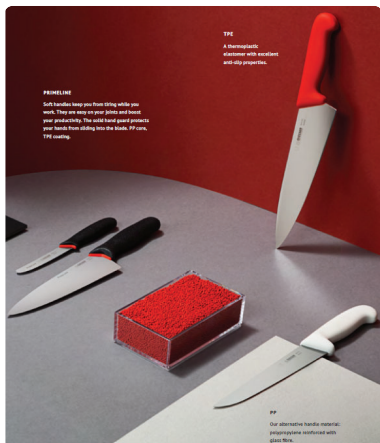

Lakidis MG130L

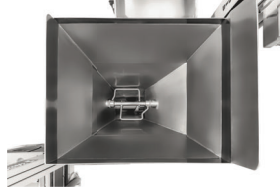
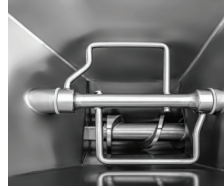

Technical characteristics	Τεχνικά χαρακτηριστικά	
Main motor	Κυρίως Μοτέρ	9,2 Kw
Premix motor	Μοτέρ Προαναμιξής	0,75 Kw
Loader motor	Μοτέρ Αναρτοήραου	1,1 Kw
Productivity	Παραγωγικότητα	800-1000 Kg/h

Lakidis ML160L

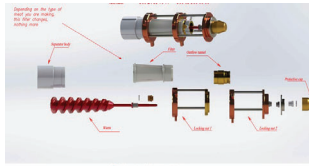

Technical characteristics	
Productivity	
Motor Power	
Hopper Capacity	

Τεχνικά χαρακτηριστικά	
Παραγωγικότητα	2500kg/hr
Μοτέρ	40 Kw
Χωρητικότητα Χοάνης	300 lt of product

Hamburger Foaming Machine

Lakidis FR200L



Technical characteristics	
Motor Power	2 x 2,2 Kw

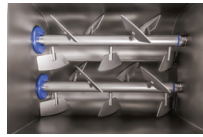

Technical characteristics	
Length	180 cm
Width with Loader	200 cm
Width without Loader	115 cm
Height with Loader	240 cm
Height without Loader	170 cm
Bowl Capacity	900 Lt
Motor Power	11 Kw
Motor Power of Loader	1.1 Kw
Required air pressure	6 bar

Technical characteristics	
PZ500 mixer	13,2 Kw
PZ500L mixer with loader	14,3 Kw
PZ500L mixer with vacuum	14 Kw
PZ500L mixer with vacuum & loader	15 Kw



Model	Capacity	Power	Dimension	Weight
ZYD-100-I	300-500kg/h	6.5/8kW	1440*630*970mm	450kg
ZYD-130-I	800-1000kg/h	13/16kw	1990*820*1300mm	850kg
ZYD-160-I	1500-2000kg/h	18.5/22kW	2130*890*1400mm	1350kg
ZYD-180-I	2500-3000kg/h	26/32kW	2420*1200*1500mm	1650kg
ZYD-180-II	3000-4000kg/h	45kW	2420*1200*1500mm	1650kg
ZYD-220-I	5000-6000kg/h	55kW	2700*1450*1650mm	2150kg

MDM



Meat Grinder



	C160G-B	C200G-B	C250G-B	C300G-B
POWER	18.5 Kws	30 Kws	45 Kws	55 Kws
CAPACITY¹	1500 Kgs/Hour	2500 Kgs/Hour	5000 Kgs/Hour	6500 Kgs/Hour
Max. Frozen Meat Block(-25°C)	50×50×100 mm	100×100×150 mm	200×200×150 mm	600×400×150 mm
DIMENSION	1450 × 1000 × 1400 mm	1700 × 1150 × 1570 mm	2000 × 1200 × 1700 mm ²	2300 × 1300 × 2000 mm



Bowl Cutter



Model:DRB-ZB125L
Voltage:380v,50hz
Power:23kw
Capacity:70-80L/TIME
Volume:125L
weight: 1380kg
Dimension: 2400*1420*1300mm
Functions: Meat Grinding Machine
Cutting Knife Speck:126/1800(low speed)/3600(high speed) rpm
Pan Discharge Speed:8/12 rpm
Cutting Knife Number:6 piесе

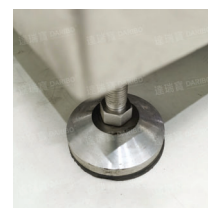



k120neo k200neo



k50neo k80neo

Bowl capacity		205 liters / 54 US liq.gal
Approximate batch size	soft meat dough	±20 to ±160 kg / ±45 to ±350 lbs.
	dogged meat dough	±20 to ±100 kg / ±45 to ±220 lbs.
Total machine power with standard motor		82 HP / 60 kW
Knife motor power standard		75 HP / 55 kW
Total machine power with Power Plus motor	optional	109 HP / 80 kW
Knife motor power Power Plus	optional	102 HP / 75 kW
Bowl motor power		4 HP / 3 kW
Hydraulic loader motor power		1 HP / 0,74 kW
Hydraulic unloading disc motor power		0,5 HP / 0,37 kW
Total consumption with standard motor	380/400 V	104 A
	460/480 V	85 A
Total consumption with Power Plus motor	380/400 V	136 A
	460/480 V	110 A
Rotational knife speed cutting	variable	1000 to 4000 rpm
	pre-programmed	1000 / 2000 / 3000 / 4000 rpm
Linear knife speed	@ 4000 rpm	up to 117 m/sec.
Rotational bowl speed cutting		6 / 10 / 14 / 18 rpm
Rotational knife speed mixing	variable	50 to 200 rpm
	pre-programmed	50 / 100 / 150 / 200 rpm
Rotational bowl speed mixing		6 / 10 rpm
Rotational speed of unloader disc		130 rpm 50 Hz / 156 rpm 60 Hz
Net weight approx.		± 3500 kg / ± 7700 lbs.
Sound pressure level dB(A) LEQ at 1 m		78 dB
Operating temperature		+5 to +40°C / 40 to 105°F
Recommended relative humidity level		20 to 90%



	K130L	K200L	K330L
Blade Driving Power	30 Kws	55 Kws	75 Kws
Bowl Driving Power	1.5 Kws	2.2 Kws x 2	2.2 Kws
BOWL VOLUME	130 L	200 L	330 L
Blade Speed	150 – 3800 rpm (Max. 4000 rpm)		
Bowl Speed	4 – 17 rpm (Max. 20 rpm)		

型号 (Model)	生产率(kg/h) Productivity	容积(L) Volume	功率(kw) Power	刀片数量(把) Knife quantity	转速(转/分) Bowl speed (rpm)	出料速度(转/分) Unloader (rpm)	刀片速度(转/分) Knife (rpm)	重量(kg) Weight	外形尺寸(mm) Dimension
ZB-80	70-75	80	11	6	7111	88	750/1500/3000	1300	1900X1500X1500
ZB-125 I	100-110	125	12	6	7111	88	750/1500/3000	1800	2100X1420X1600
ZB-125 II	100-110	125	33.2	6	7111	88	300/1000/3000/4000	2000	2100X1420X1600
ZB-200	170-180	200	60	6	7.5/10/15	82	200/1800/3600	3500	2950X2400X1950
ZB-200 (变频调速)	170-180	200	65	6	7.5/10/15	变频调速	200/2100/4200	4800	3100X2420X2300
ZB-330	270-310	330	82	6	6/12	无级调速	200/1800/3600	5000	3855X2900X2100



ZKB-200

Clippers-manual, semi-automatic, automatic

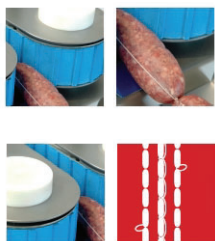

**LX13
LX15**

LEGASALSICCE
STRING LINKER
ATADORA

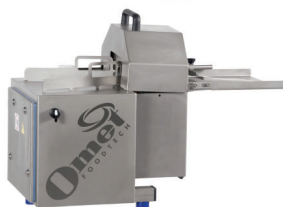

LX13



LX15



DATI TECNICI	TECHNICAL DATA	DATOS TECNICOS	LX13	LX15	
Motore legatore	Extractor motor	Motor atador	kW	0,75	0,75
Motore estrattore	Linker motor	Motor extractor	kW	-	0,75
Produzione Max.	Max production	Producción Max.	pcs/min	100	120
Peso	Weight	Peso	kg	45	80



CLIPS from food-grade aluminium

AUTOMATIC (two-clip)

Closes two ends of sausage loafs at the same time. May be completed with: loop tray; date labelling unit; adapters for different filler types; loop or twine dispenser. Table mounted or on a roller frame.

TECHNOCLIP CORUND 2-2.5 AUTOMAT

TECHNOCLIP CORUND 2-2.5 AUTOMAT ON A FLAT CLIP

Up to 8 tons /shift, with casing diameter up to 80 mm

TECHNOCLIP CORUND 2-3.0 AUTOMAT

Up to 10 tons /shift, with casing diameter up to 120 mm



CLIPPER – AUTOMAT ON CONTINUOUS CLIP TECHNOCLIP CSA 21-100

TECHNICAL PARAMETERS

Caliber of casing, mm	40-100
Clipping speed	up to 100 cycles per minute
Clips type and size	continuous clips 15/18
Loop type	20/100
Cut-off knife	automat
Overall dimensions	128x1000x1700
Weight, kg	500
Electric power supply	380 V 50 HZ
Power	3.5 kW



U-SHAPED CLIPS

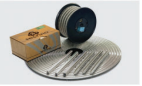

CONTINUOUS CLIPS



OPTIONAL EQUIPMENT

Table or roller frame-mounted
Automatic looping tray
Automatic string dispenser
Movable casing brake
Special design of TechnoClip Corund 2-2.5 F Automaton for the flat clip "KD" allows to stamp the date of production on the clip.
Dynamic scales for working with non-porforming operators



TECHNICAL PARAMETERS

Caliber of casing, mm	30-80
Time of one clip placing, sec.	1
Clips for the model 2-2.5	E-210, E220, E230, M1, M2, M3
Clips for the model 2-2.5 F	KD1, KD2, KD3, KD4
Cut-off knife	automat
Overall dimensions	450x240x850
Weight, kg	95



Clippers Manual and Pneumatic



Clippers Semi-Automatic



Clippers Automatic



INNOVATION & PERFECTION



RVF 327

Simple operation everyone understands

RVF 327 and 330 are designed for small and medium-sized companies with frequently changing varieties and normal sausage meat quantities. The series 300 is characterised by reliable, quick and easy cleaning, minimal leftovers and low energy costs. The vane cell feed system made of wear-resistant stainless steel guarantees a long service life and the highest product quality. It ensures gentle transport of all fillers and minimum air pockets in the sausage meat.

The touchscreen guarantees simple operation. The clipper socket which is a standard feature permits the driving of various clipping devices and/or additional machines. The fold hopper is available in volumes of 100 and 160 litres.

The RVF 327 and 330 can also be equipped with a rotating or rigid case holding device. This makes it easier to twist off artificial or natural sausage skins.

The all-rounder for all sizes of business

Series 400 is flexible and universal. This is as suitable for the smaller or medium-sized meat-processing operations as it is for larger, highly specialised companies. Its smooth surface, hygienically designed, space-saving machine housing, is self-supporting and made entirely of stainless steel. The reinforced model of the large cell-feed system guarantees exact portioning accuracy for a maximum service life. No crushing or smearing. It ensures that all fillers are transported gently, especially for larger sausage meat charges, larger pieces of meat or raw sausage applications. The vane cell feed system are available with eight, 12 or 14 vanes, alternatively also with blind vanes. Thanks to the newly developed lifting device, the hopper of the RVF 400 - available in different sizes - can be filled simply and without any mess.

- 100 litre folding hopper
- 160 litre folding hopper
- 250 litre folding hopper
- 350 litre folding hopper

The touchscreen control can be easily operated. It is suitable for all applications, even for controlling various clip machines, REX suspension lines and attachments. The tried-and-tested "REX Servo drive" rounds off the innovative control concept. The optional case holding device makes it easy to twist off artificial and natural sausage skins.

Features that characterise the Series 400:

- The grand appearance supports the product change and cleaning
- Modern servo drive concept for accurate portioning
- Minimal energy consumption
- Very simple operation thanks to touch screen operation
- Extremely low-noise and smooth operation
- Simple to fill thanks to folding hopper
- Large feed system gently transports the fillings

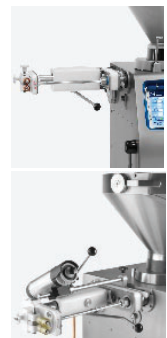

TYPE	Filling capacity	Hopper size	Servo twisting motor	Filling pressure
RVF 327	2.700 kg/h	100/160 l	no	40 bar
RVF 436 S	3.600 kg/h	100/160/250/350 l	yes	45 bar

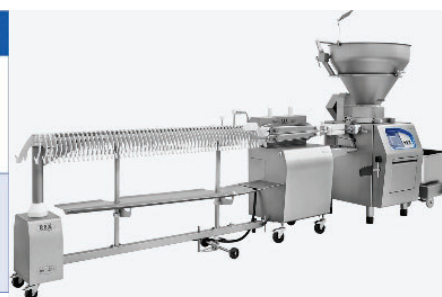

RVF 436 S

Smoking Solution



CONTROLLER SYSTEM

Our control system YXC1.50 is adopted by PLC and touch screen. It is user-friendly and easy to operate. The large memory could be for 100 programs, each allows up to 20 steps. All kinds of data like temperature of chamber, core of product, humidity and time are all controlled, indicated and monitored by this system.

Model	YX1711	YX2011	YX2012	YX2013	YX2014	YX2024
Trolley quantity	1	1	2	3	4	4
Trolley size	0.9*1*1.7 m		1*1*2 m			
Fan power	3 kW	4 kW	2*4 kW	3*4 kW	4*4 kW	
For electric heating	30 kW	30 kW	60 kW	90 kW	120 kW	
For steam heating	75 kg/h	75 kg/h	150 kg/h	225 kg/h	300 kg/h	
For gas heating	30 kW	30 kW	60 kW	90 kW	120 kW	

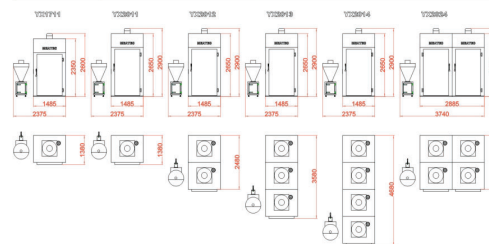

Packaging Machine

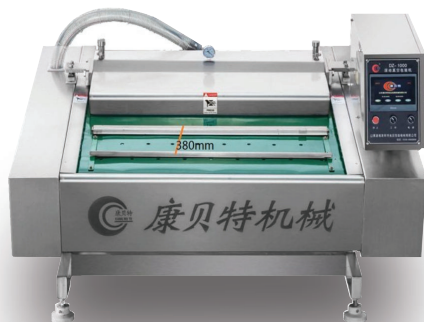

Specifications

- Options: 1 sealing bar (GB1000/1S) and 2 sealing bars (GB1000/2S)
- Adjustable working plate angles for convenient vacuum packing of liquid products
- SUS304 stainless steel guarantees most durable service life, no corrosion, no deformation
- BUSCH 200 vacuum pump
- Computer program controlled
- Speed: 3-6 cycles/minute
- Power: 6.5 KW
- Machine size: 1580mm×1800mm×1300mm



Belt type vacuum packaging machine DZ1000/1S

Packing Machine



Model Termoformer

MODEL	WIDTH	STROKE	LOADING AREA
TH 285-240	285	240	1400
TH 285-270	285	270	1300
TH 285-300	285	300	1100
TH 320-240	320	240	1400
TH 320-270	320	270	1300
TH 320-300	320	300	1100
TH 355-240	355	240	1400
TH 355-270	355	270	1300
TH 355-300	355	300	1100
TH 420-240	420	240	1400
TH 420-270	420	270	1300
TH 420-300	420	300	1100

Specification Termoformer

Standard

- Display prepared for remote connection and control through Ethernet; for example for software updates
- Synchronisation for peripheral devices such as a labeler, printer, filler or loading robot
- Control cabinet heating to prevent condensation on electrical circuits

Optional

	1	2	3
> Length	3000		
> Pump	63 m³	100 m³	160 m³
> Gas	Inert	Oxygen	
> Exit Conveyor	Rollers	Powered chain belt	
> Film	Print sensor	Euro hole	

	MACHINE LENGTH	MACHINE WIDTH	MACHINE HEIGHT	VOLTA GE*	POWER CONSUMPTION	AIR	WATER
TH 285/320/355	3500	727	1708	400V-3-50Hz	7,5 kW	6 bar/200 Ltr/min	2,1Ltr/min/1,5 bar
TH 420	3500	792	1708	400V-3-50 Hz	7,5 kW	6 bar/200 Ltr/min	2,1Ltr/min/1,5 bar

	FILM THICKNESS	MAX DEPTH
FLEXIBLE FILM	< 300 µ	95
RIGID FILM	Ca. 300-400 µ	60
SKIN PACK	x	20

SPECIFICATIONS TABLE TOPS



Liquid insert plate



Cabinet For T2,T3&T4

	SEAL LENGTH	MAX. PRODUCT HEIGHT	USEFUL CHAMBER SIZE (WxDxH)	OUTSIDE DIMENSION (WxDxH)	STANDARD VOLTAGE*	POWER CONSUMPTION	WEIGHT
TABLE TOP T2	270	100	270 x 310 x 100/140**	365 x 500 x 300/340**	230-1-50 Hz	0,4/0,5 kw	25 kg
TABLE TOP T3	320	160	320 x 330 x 160	430 x 550 x 410	230-1-50 Hz	0,5/0,7 kw	50 kg
TABLE TOP T4	420	180	max. 420 x 370 x 180	530 x 590 x 460	230-1-50 Hz	0,7/1,3 kw	60 kg
TABLE TOP T5	320	95	800 x 320 x 95	985 x 515 x 430	230-1-50 Hz	1,3 kw	115 kg

SEAL CONFIGURATION

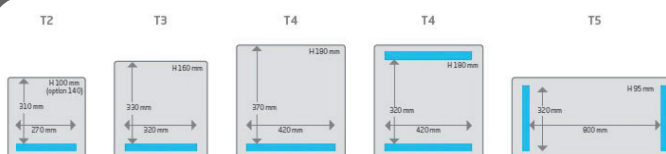

*Dimensions in mm.

SPECIFICATIONS D1,D3,D4&D6



DOUBLE CHAMBER D6

	SEAL LENGTH	MAX. PRODUCT HEIGHT	USEFUL CHAMBER SIZE (WxDxH)	OUTSIDE DIMENSION (WxDxH)	STANDARD VOLTAGE*	POWER CONSUMPTION	WEIGHT
STAINLESS STEEL COVER & FLAT WORKING SURFACE							
D1	4 x 620	230	620 x 520 x 230	1440 x 920 x 1205	400-3-50 Hz	4,4 kW	350 kg
D3	4 x 820	250	820 x 700 x 250	1865 x 1100 x 1230	400-3-50 Hz	6,2-9,7 kW	600 kg
D4	4 x 920	270	920 x 870 x 270	2050 x 1275 x 1245	400-3-50 Hz	6,2-9,7 kW	720 kg
ALUMINUM COVER & CHAMBER							
D6	4 x 600	180	610 x 510 x 180	1345 x 720 x 1040	400-3-50 Hz	4,4 kW	240 kg

SEAL CONFIGURATION

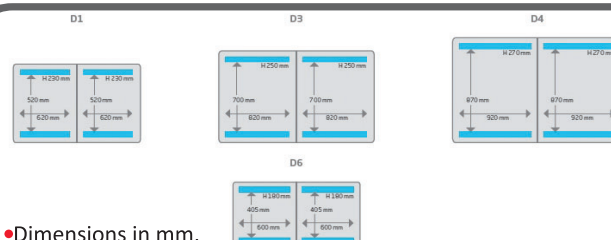

*Dimensions in mm.

Sausage Cutter



acs-1809

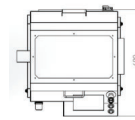
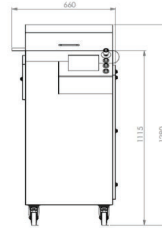

Brand	Description
"KFT"	Sausage Separator Machine Model: ASC-1809
	Cutting capacity up to 1.500 cuts per minute.
	Cutting and portioning function.
	Effective sausage knot recognition, two readings, infeed and outfeed knot.
	From 2 mm knot length.
	Range of sausage adjustment: 4-45 mm.
	Ergonomic infeed and outfeed heights.
	Automatic recognition of the sausage knot.
	Technology SERVO LENZE
	Touch Screen 5"
	Cut precision <1mm
Speed up to 1200 mm/s	
Different speed on conveyor belts, for along the product.	

TECHNICAL DATA:

- Dimensions: 700x1135x555mm
- Weight: 70 kg
- Power: 1kW
- Voltage and frequency: 230 / 400V 50-60Hz
- Material: AISI 304 and AISI 316L Stainless Steel

OPTIONAL:

- Ergonomic work table.

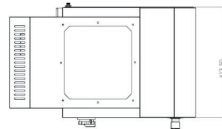
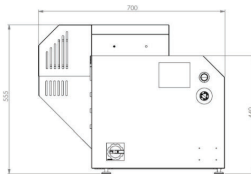

cs-500

Sausage Peelers

Incorporated pump/vacuum generator lower

Special blade for unique cut, without cutting marked

High performance suction pipe

Product entry equipped with anti-burn air curtain

New presence sensor for product

Product collector bathed in water and easily removable for washing

Air switch and automatic steam system with presence sensor for product, halting automatically (air and steam) and reducing energetic consume (both standard and cocktail configuration).

Display and regulation of the flow rate

Easy height adjustment for different sausage formats (sausage diameter between 15 and 34mm)

New anti-breakage support roller for casing peeled

Spacious tank without corners for casing peeled.

Tank with hygienic design

Supervising window on enclosure for peeled casing.

Automatic light for enclosure peeled casing.

Wheels with safety brake system for easy handling

Safety relay in accordance with the EC regulation

Full construction in stainless steel 304/316.



ASP-3000

- ▶ High Productivity :
Up to 300 meter/minute



ASP-200

- ▶ Productivity :
Up to 210 meter/minute



MSP-3008

- ▶ Semi-Automatic.
For small and medium producers.

Cooked Meat Slicing Cutting Machine



Model	DRB-120
Voltage/Power	220v,380v/50hz,60hz/1.5kw
Dimension	1350*600*1250mm
Neigh Weight	115kg
Capacity	150-800kg/h
Meat Cutting Thickness	1-40mm(adjusted)
Inlet Mouth/Outlet Mouth	120mm/130mm

Model	DRB-180(Rotary knob)
Voltage/Power	380v/50hz,60hz/1.5kw
Dimension	2600*900*1100mm
Neigh Weight	235kg
Capacity	200-1000kg/h
Meat Cutting Thickness	0.6-40mm(adjusted)
Inlet Mouth/Outlet Mouth	180mm/210mm

Model	DRB-QR160 (Touch Screen)
Voltage/Power	380v/50hz/1.25kw
Dimension	2350*580*1500mm
Neigh Weight	370kg
Capacity	60-260 pieces/min
Meat Cutting Thickness	1-30mm(adjusted)
Inlet Mouth/Outlet Mouth	160mm/160mm

Model	DRB-21k
Voltage/Power	380v,50hz/3.4kw
Dimension	1775*790*1280mm
Neigh Weight/Inlet Mouth Size	230kg/650*210*165mm
Capacity	190/220 pics/min
Cutting Thickness	1-38mm
Meat Temperature	0C-4C



Model	DRB-17k
Voltage/Power	380v,50hz/3.4kw
Dimension	1700*800*1220mm
Neigh Weight/Inlet Mouth Size	400kg/640*170*135mm
Capacity	168 pics/min
Cutting Thickness	1-40mm
Meat Temperature	0C-4C

Model	DRB-25k
Voltage/Power	380v,50hz/4.75kw
Dimension	1850*950*1380mm
Neigh Weight/Inlet Mouth Size	550kg/660*250*170mm
Capacity	190/220 pics/min
Cutting Thickness	0.5-40mm
Meat Temperature	0C-4C

Model	DRB-36k
Voltage/Power	380v,50hz/5.2kw
Dimension	2050*1150*1480mm
Neigh Weight/Inlet Mouth Size	700kg/650*360*200mm
Capacity	190/220 pics/min
Cutting Thickness	1-40mm
Meat Temperature	0C-4C

Model	DRB-21k
Voltage/Power	380v,50hz/4kw
Dimension	2050*770*1220mm
Neigh Weight/Inlet Mouth Size	230kg/750*210*230mm
Capacity	190/220 pics/min
Cutting Thickness	1-38mm
Meat Temperature	0C-4C

Model	DRB-25k
Voltage/Power	380v,50hz/4.4kw
Dimension	2605*925*1320mm
Neigh Weight/Inlet Mouth Size	600kg/650*250*160mm
Capacity	190/220 pics/min
Cutting Thickness	1-38mm
Meat Temperature	0C-4C

Model	DRB-JG260
Voltage/Power	380v,50hz/1.12kw
Dimension	720*680*1500mm
Neigh Weight/Inlet Mouth Size	95kg
Capacity	1900mm
Cutting Thickness	210mm
Meat Temperature	220mm

Bacon Ham Beef Mutton Slicing Cutting Machine with Belt



Model	DRB-21k
Voltage/Power	380v,50hz/4kw
Dimension	2050*770*1220mm
Neigh Weight/Inlet Mouth Size	230kg/750*210*230mm
Capacity	190/220 pics/min
Cutting Thickness	1-38mm
Meat Temperature	0C-4C

Model	DRB-25k
Voltage/Power	380v,50hz/4.4kw
Dimension	2605*925*1320mm
Neigh Weight/Inlet Mouth Size	600kg/650*250*160mm
Capacity	190/220 pics/min
Cutting Thickness	1-38mm
Meat Temperature	0C-4C

Model	DRB-JG300
Voltage/Power	380v,50hz/1.5kw
Dimension	790*705*1610mm
Neigh Weight/Inlet Mouth Size	108kg
Capacity	2150mm
Cutting Thickness	240mm
Meat Temperature	295mm

Model	DRB-JG360
Voltage/Power	380v,50hz/2.25kw
Dimension	1200*900*1760mm
Neigh Weight/Inlet Mouth Size	150kg
Capacity	2715mm
Cutting Thickness	350mm
Meat Temperature	360mm

Model	DRB-GR200
Voltage/Power	220V,50HZ/1.5KW
Dimension	1250*600*1100MM
Neigh Weight	200KG
Volume/Input Capacity	200L/Time/60kg/h
Vacuum Drum Rotation Speed	15/speed regulation for choice
Vacuum Degree	-0.08Mpa

Model	DRB-GR400
Voltage/Power	380V,50HZ/2.2KW
Dimension	1260*800*1380MM
Neigh Weight	270KG
Volume/Input Capacity	400L/Time/100kg/h
Vacuum Drum Rotation Speed	7/speed regulation for choice
Vacuum Degree	-0.08Mpa

Model	DRB-GR600
Voltage/Power	380V,50HZ/2.2KW
Dimension	1330*1020*1573MM
Neigh Weight	330KG
Volume/Input Capacity	600L/Time/200kg/h
Vacuum Drum Rotation Speed	7/speed regulation for choice
Vacuum Degree	-0.08Mpa

Model	DRB-GR800L
Voltage/Power	380V,50HZ/2.2KW
Dimension	1490*1000*1573MM
Neigh Weight	400KG
Volume/Input Capacity	800L/Time/300kg/h
Vacuum Drum Rotation Speed	7/speed regulation for choice
Vacuum Degree	-0.08-0.06Mpa

Model	DRB-GR1000L
Voltage/Power	380V,50HZ/3KW
Dimension	1760*1020*1573MM
Neigh Weight	480KG
Volume/Input Capacity	1000L/Time/500L/time
Vacuum Drum Rotation Speed	7/speed regulation for choice
Vacuum Degree	-0.08-0.06Mpa

Meat Vacuum Pickle Making Machine

Heavy Meat Vacuum Pickle Making Machine



Model	DRB-YGR1500
Voltage/Power	380V,50HZ/8.2KW
Dimension	2600*1300*1900mm
Neigh Weight	1000KG
Volume/Input Capacity	1500L/Time, 600-900kg/h
Vacuum Drum Rotation Speed	1 ~ 12rpm
Vacuum Degree	-0.08Mpa

Model	DRB-YGR2000
Voltage/Power	380V,50HZ/8.2KW
Dimension	2900*1700*2030mm
Neigh Weight	1500KG
Volume/Input Capacity	2000L/Time,800-1200kg/h
Vacuum Drum Rotation Speed	1 ~ 12rpm
Vacuum Degree	-0.08Mpa

Model	DRB-YGR2500
Voltage/Power	380V,50HZ/8.2KW
Dimension	3270*1880*2300mm
Neigh Weight	2000KG
Volume/Input Capacity	2500L/Time,1000-1500kg/h
Vacuum Drum Rotation Speed	1 ~ 12rpm
Vacuum Degree	-0.08Mpa

Model	DRB-YGR3200
Voltage/Power	380V,50HZ/9.2KW
Dimension	3270*1880*2500mm
Neigh Weight	2500KG
Volume/Input Capacity	3200L/Time
Vacuum Drum Rotation Speed	1 ~ 12rpm
Vacuum Degree	-0.08Mpa

Double Molding Machine

Model	TYPE:DRB-CJ300
Voltage/Power	VOLTAGE:380v/50z POWER:4.7KW
Dimension	NET WEIGHT(KG):350kg CAPACITY:5.6M/min VOLUME:26L BLENDING SPEED:30-100RPM/MIN AIR SUPPORTED: 0.4-0.6 Mpa MEAT GROOVE LENGTH: 600mm TOTAL DIMENSION:3300*1160*1880mm MACHINE DIMENSION:2130*1160*1880mm CONVEYOR DIMENSION:1282*862*885mm THE PACKING SHEET:TOFU SKIN



Sausage Stuffing Machine and Sausage Clipping Machine



Model	DRB-TC600
Voltage/Power	*/
Dimension	1860*580*1430mm
Neigh Weight	165kg
Capacity	10-12 times/min
Working Temperature	Above zero degree
Air Pressure Strength	0.4-0.8Mpa

Model	DRB-DK810
Voltage/Power	*/
Dimension	900*420*830mm
Neigh Weight	28kg
Capacity	10 times/min
Working Temperature	Above zero degree
Air Pressure Strength	0.4-0.6Mpa

Model	Meat Skewering Machine Model: JL-3000
Capacity	5500 pcs/h.
Stick size	250-300 mm, 3-3.5 mm.
Motor	160W
Air compressor	0.7 Mpa
Size	500x1200x1180 mm.
Weight	180 kg.



Peanut Butter Mill Colloid Grinder GMS-130



Item	Specifications
Capacity	150-200kg/hr
Rated voltage	380V/50HZ/3-phases
Motor Speed	2930rpm
Power	11kw
Outer dimension(L*W*H)	1220*660*1080mm
Weight	400/420kg
Price Term	FOB Shanghai
-1A: semi-stainless steel	US\$2300
-2B: full stainless steel	US\$2800
-3C: screw feed forcing device	US\$350
-4S: spare parts rotor+stator set	US\$550

Sausage Smoking Machine

Model	DRB-YX50
Voltage/Power	220v,380v/50hz / 9.5kw
Dimension	800*850*1900mm
Neigh Weight	350kg
Capacity	50kg/times
Working Temperature	120 C



Our Customer



Sausage | Chinese sausage
Pork | Isaan sausage



SMILE(2019) COMPANY LIMITED
31 SOI PATTANAKARN 44 SUANLUANG
SUANLUANG BANGKOK 10250



Scan to me



SMILE(2019) Co., Ltd



(66) (083) 448 9977